

- Notes
- 1) Supporting steelwork and anchor bolts to be designed and furnished by others.
 - 2) All supporting steel must be flush and level at top.
 - 3) Beams should be selected in accordance with accepted structural practice.
 - 4) Supporting steel will be greater than or equal to the length of the unit's base.
 - 5) Unit may not be point supported. Support must extend the entirety of unit length.
 - 6) Each beam should be designed, as a minimum, for 65% of the total unit operating weight applied as a uniformly distributed load.
 - 7) Weights include all of the options and accessories.

Model Number	Shipping Weight	Operating Weight
TRF-1014N-C80Gx26E	10516	12346

ORDER NO:
DATE: **9/18/2023 4:32:53 PM ConfigVer=1**

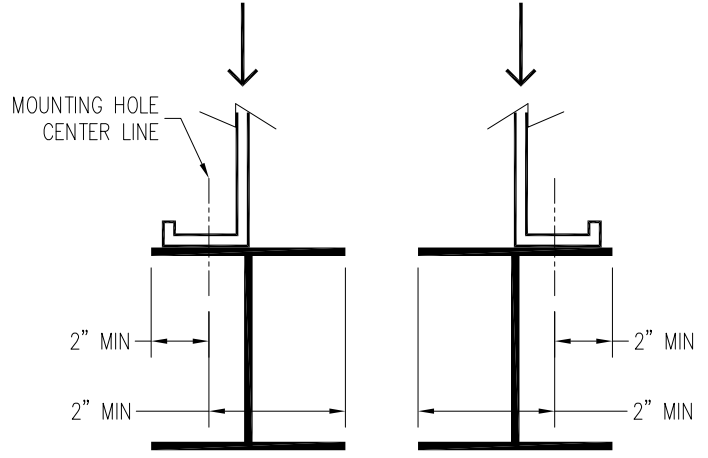

SECTION A-A

**TrilliumSeries™ Adiabatic Cooler
Six Fan Unit Support**

DRAWING NUMBER: