

PLAN VIEW

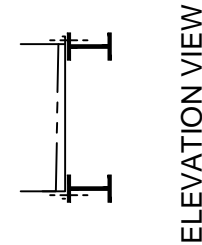
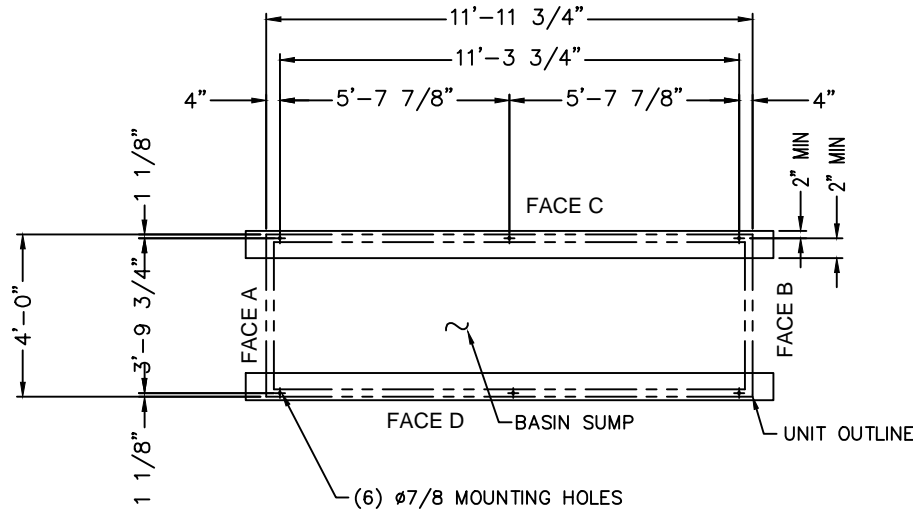

ELEVATION VIEW

Model Number	Approx, Shipping Weight	Approx, Operating Weight
PCC-0078-0412N006	5340	7640
PCC-0090-0412N010	5380	7680
PCC-0106-0412N010	6040	8380
PCC-0122-0412N015	6810	9180
PCC-0128-0412N015	7090	9480
PCC-0118-0412N010	7570	9990
PCC-0134-0412N015	7880	10310

Notes

- 1) Drawings are not to scale. All dimensions are in feet and inches. Weights are in pounds and include options and accessories.
- 2) Operating weight and weight loading are for units with water level in basin at overflow.
- 3) Unit support beams and anchor bolts to be designed and furnished by others.
- 4) Support beams must be flush and level at top.
- 5) All supporting steelwork must be designed in accordance with accepted structural practice. Maximum deflection of steelwork under unit to be 1/360 of span, not to exceed 1/2".
- 6) Each beam should be designed, as a minimum, for 65% of the total unit operation weight applied as a uniformly distributed load.

ORDER NO:

DATE:



BALTIMORE AIRCOIL COMPANY

**PCC Evaporative Condenser
Tabulated Steel Support - Plan A**

DRAWING NUMBER:
SS-PCI-0412